



Thorn Mead

Adeyfield Road, Hemel Hempstead, , HP2 5GU

£1,250 pcm



# Property Summary



SECOND FLOOR  
639 sq.ft. (59.3 sq.m.) approx.

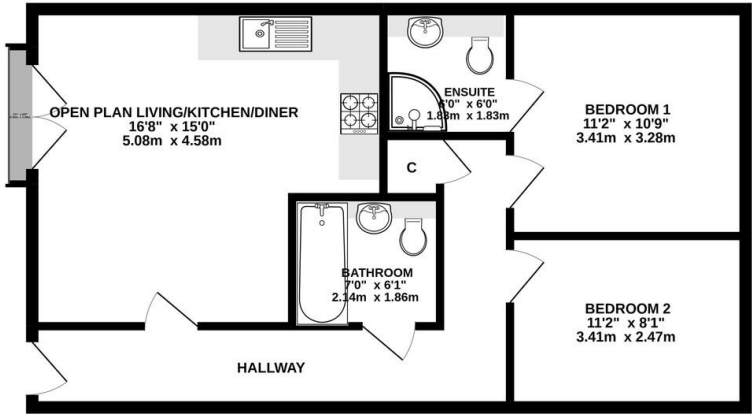

TOTAL FLOOR AREA: 639 sq.ft. (59.3 sq.m.) approx.  
Whilst every attempt has been made to ensure the accuracy of the floorplan contained here, measurements of doors, windows, rooms and any other items are approximate and no responsibility is taken for any error, omission or mis-statement. This plan is for illustrative purposes only and should be used as such by any prospective purchaser. The services, systems and appliances shown have not been tested and no guarantee as to their operability or efficiency can be given.  
Made with Metapix (1/2020)

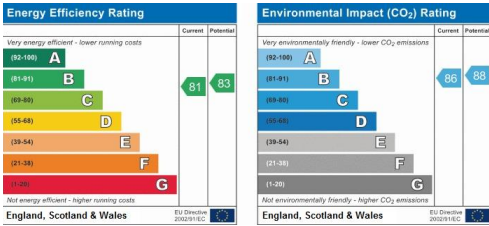

- Two bedroom Apartment
- Two bathrooms
- En-suite
- Balcony
- Open plan kitchen
- Private entrance hall
- Local amenities
- Schools nearby
- Ideal for a family
- Available soon

38 Court Parade  
Wembley  
Middlesex  
HA0 3HS

www.propertyhubltd.com  
info@propertyhubltd.com  
0208 903 1002

Agents Note: Whilst every care has been taken to prepare these particulars, they are for guidance purposes only. All measurements are approximate are for general guidance purposes only and whilst every care has been taken to ensure their accuracy, they should not be relied upon and potential buyers/tenants are advised to recheck the measurements